

# Thermowire TDB Kits

For Installation Directly Under Tile

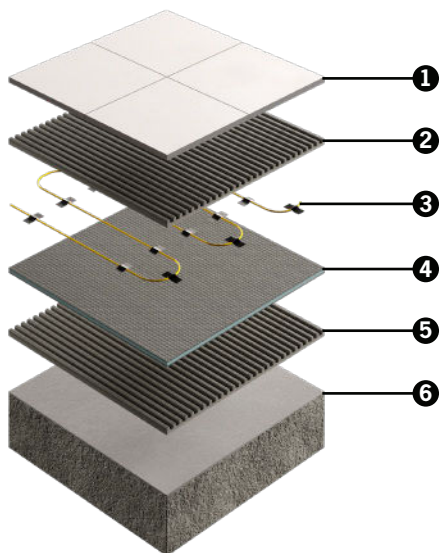

- ① Tiled floor finish
- ② Flexible tile adhesive
- ③ Thermowire system
- ④ Optional Econoboard insulation board
- ⑤ Flexible tile adhesive (if insulation is installed)
- ⑥ Prepared concrete or timber substrate



### Lifetime Warranty

We are so confident of the quality of our Thermowire Underfloor Heating systems, made in the United Kingdom, that we give each system a warranty that lasts a Lifetime with 3 year warranty on our Thermostats.

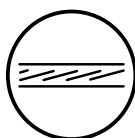

### Loose Wire Flexibility

Thermowire loose wire offers flexibility to fit around your room shape and fixtures and to adjust your cable spacing to achieve your desired heat output.



### IP68 Protection Rating

Safe for use in bathrooms, showers and other wet room locations without any electrical hazard.



### Minimal Height Build-up

The cable system is only 3.5mm thick with a low profile 4mm cold tail which can be concealed within the tile adhesive layer.



**Kit Includes:** Thermowire Cable, Fixing Tape, Black Dual Thermostat (5246), Floor Temperature Sensor, Sensor Conduit, Cable Monitor (6025), Installation Guide & Warranty Form.

### Technical Data

Thickness	3.5mm*
Max. Temperature	28°C**
Protection Rating	IP68
Warranty	Lifetime on cable, 3 years on Thermostat
Conductor Type	Single Ended
Cold Tail Length	5m

\*Cold tail is 4mm thick

\*\*Regulated by floor sensing thermostat

## Installation Overview

Thermowire Underfloor Heating cables are designed for installation in small, awkward areas. This overview gives a guide to the basics of the installation. Always read the instructions in full before attempting your own installation.

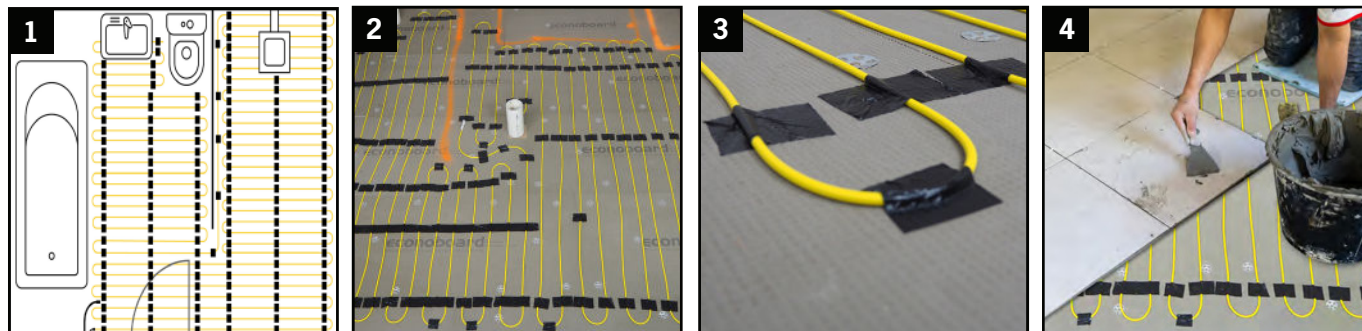

### Plan out the installation

Determine the location of the thermostat and floor sensor, calculate the available floor space (excluding floor mounted fixtures) and calculate the required cable spacing. Check you have all the required components.

### Layout the Thermowire cable

Run the heating cable back and forth throughout the room using the spacing calculated and fix in position using the tape provided.

**NEVER CUT THE YELLOW CABLE.**

### Secure heating cables in place

Once all the cables are fixed into position go back and add additional strips of tape to ensure the cable is lying flat across the entire floor and the tape is tucked firmly around the heating cable with no air pockets.

### Install floor finish

Take images of the installed cables before installing the floor finish. Cover the heating cables with a flexible cement based self-levelling or tile directly on top using a full bed of tile adhesive.

**This is an illustrative guide only. Read the instruction manual that is supplied with the system in full before attempting installation.**

#### How to calculate spacing of Thermowire

$$\frac{\text{Available floor space (m}^2\text{)} \times 100}{\text{Cable Kit Length (m)}} = \text{Cable Spacing (cm)}$$

Average cable spacing based on 150W/m<sup>2</sup> is 9cm. Minimum cable spacing is 5cm and maximum cable spacing is 11cm.

## Thermowire TDB Kits

Stock Code	Size (m)	Area (m <sup>2</sup> )	Output (W)	Amps (A)	Resistance Ω
101502TDB	14	1.0 - 1.4	185	0.77	286.0
101503TDB	22	1.5 - 2.4	300	1.25	176.0
101504TDB	33	2.5 - 3.4	450	1.88	118.0
101506TDB	44	3.5 - 4.4	600	2.50	88.0
101508TDB	55	4.5 - 5.4	750	3.13	71.0
101510TDB	66	5.5 - 6.9	900	3.75	59.0
101512TDB	86	7.0 - 8.9	1200	5.00	44.0
101515TDB	110	9.0 - 10.9	1500	6.25	35.0
101518TDB	132	11.0 - 12.9	1800	7.50	29.0
101521TDB	154	13.0 - 14.9	2100	8.75	25.0
101524TDB	176	15.0 - 18.0	2400	10.00	22.0

Area based on approximately 150W/m<sup>2</sup> for installation directly below tiles.