

Econoboard Insulation

Uncoated and Coated Insulation Boards

Installation Guide



Technical Specifications

Econoboard Coated Insulation Boards have an extruded polystyrene core with a fibre reinforced cement coating on both sides. Econoboard Uncoated Insulation Boards are an extruded polystyrene board designed for use on a concrete substrate.

Econoboard Coated is typically used on a timber substrate (See Diagram 1) as this is easy to screw down and provides the subfloor with additional lateral stability. Econoboard Uncoated does not provide lateral stability so is used on a concrete substrate (See Diagram 3) or an already stable subfloor.

It is recommended to install Econoboard Coated Boards in bathrooms or any other wet rooms (See Diagram 2).

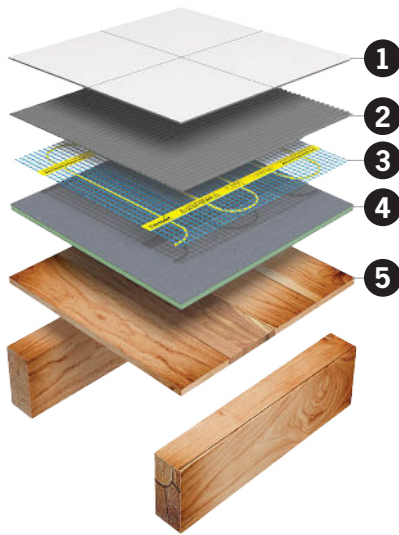

1. Tiles
2. Flexible Tile Adhesive
3. Thermonet Heating Mat
4. Econoboard Coated + fixing screws and washers
5. Timber Substrate

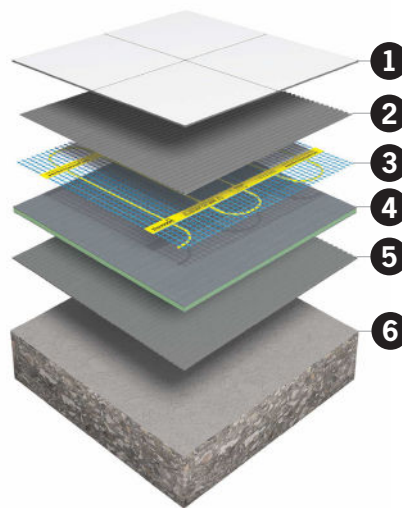

1. Tiles
2. Flexible Tile Adhesive
3. Thermonet Heating Mat
4. Econoboard Coated
5. Flexible Tile Adhesive
6. Concrete Substrate

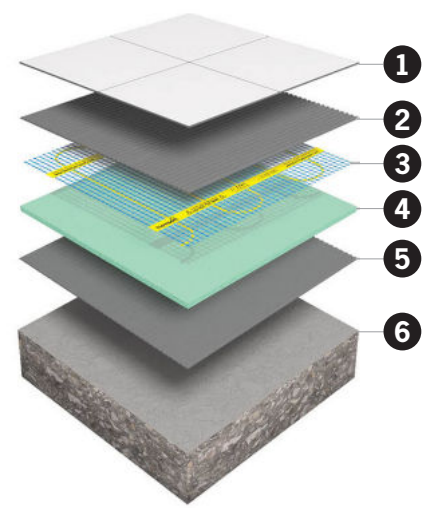

1. Tiles
2. Flexible Tile Adhesive
3. Thermonet Heating Mat
4. Econoboard Uncoated
5. Flexible Tile Adhesive
6. Concrete Substrate

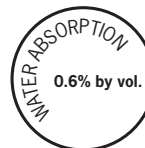

Stock Code	Thickness (mm)	Board Size (m)	Econoboard	Pack Quantity	Pack Area (m ²)	R Value (m ² k/w)
6106	6	1.2 x 0.6	Coated	8	5.76	0.15
6110	10	1.2 x 0.6	Coated	6	4.32	0.27
6012	6	1.2 x 0.6	Uncoated	20	14.4	0.18
6014	10	1.2 x 0.6	Uncoated	10	7.2	0.3

Stock Code	Description	Unit
6015	100mm Reinforcing Tape 25m roll*	Ea
6016	Zinc Fixing Washer (35mm)	pk 100
6022	Fixing Washers (32mm) and Screws	pk 100

*Allow 2m of Tape per board



6015 Reinforcing Tape



6016 Zinc Fixing Washers



6022 Fixing Washers and Screws

Econoboard Installation

1. Measure your floor space and calculate how many boards you will need using the simple formula below.
2. Cut the boards to size to suit your room layout. Econoboard coated can be cut very easily using a sharp blade or wood saw. Please take appropriate care when using sharp tools.
3. Ensure your substrate is secure, clean and free from dust and loose particles. Set out your cut boards onto the area in an offset brick pattern.
4. Fix boards to the substrate
 - For a **timber** substrate:
 - Fix the coated Econoboards in position using fixing screws and washers (6022) at 300mm centres. Allow approximately 10 mechanical fixings per board, fixing in the middle of the board as well as round the perimeter. This will maximise the strength and lateral stability of the floor.
 - Alternatively, you can fix coated Econoboards into position using a full bed of flexible cement based tile adhesive
 - Econoboard Uncoated is not suitable for use on a timber substrate
 - For a **concrete** substrate, fix either coated or uncoated Econoboards into position using a full bed of flexible cement based tile adhesive.

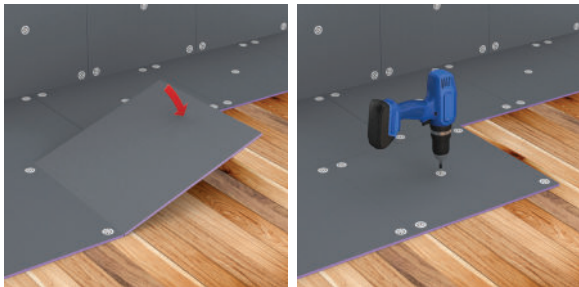

Screwing down using fixing screws and washers.

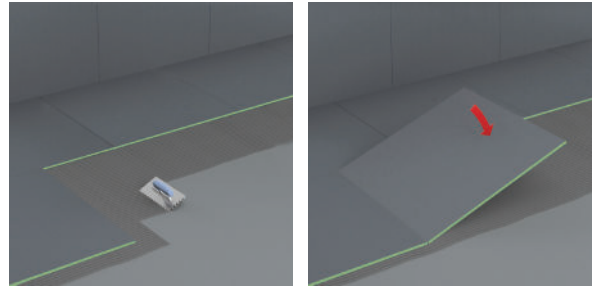

Gluing down with a full bed of flexible tile adhesive.

Please note the following when gluing down the boards with a flexible cement based tile adhesive.

- For good adhesion to the substrate, it is important to mix adhesives according to the powder to water ratio that is stipulated by the manufacturer which is wetter than what is normally used but is important as the boards will absorb some moisture. Using a notched trowel, spread enough adhesive for one board at a time to prevent adhesive from drying and forming a skin between board application. Lay the Econoboard onto the adhesive taking care to squeeze out any air pockets in the adhesive.
- For a bathroom or wetroom it is recommended to use Econoboard Coated as Uncoated Econoboard is not recommended for use where a waterproofing layer will be applied directly over the insulation. When installing Econoboard over a waterproofed substrate the boards will need to be glued down with a full bed of flexible cement based tile adhesive as using the fixing screws and washers will compromise the waterproofing layer.

5. For a more secure finish make sure all boards are flush and tape over seams using Reinforcing tape (6015).

- ⚠ THIS INSULATION IS FOR OVER SUBSTRATE APPLICATIONS AND NOT DESIGNED TO COVER BUILDING REGULATIONS
- ⚠ ENSURE THE SUBSTRATE IS STABLE AND CLEAN BEFORE INSTALLING ECONOBOARD
 - When gluing, ensure all air pockets are squeezed out when laying the Econoboard onto the adhesive.
 - Econoboard will compress or puncture under low surface area impact.
- ⚠ DO NOT LAY ON TOP OF UNDERFLOOR HEATING
- ⚠ MAKE SURE YOU DO NOT SCREW DOWN INTO WATER PIPES OR ELECTRICAL CABLES
- ⚠ TAKE CARE TO ENSURE ALL JOINS ARE FLUSH AS POSSIBLE, TAPING IF NECESSARY



Contact Us

Phone: 1300 368 631 | Technical Helpline: 1300 989 464
sales@thermogroup.com.au | www.thermogroup.com.au