

# Thermonet Mesh 150W/m<sup>2</sup> TDB Kits

For Installation Directly Under Tile

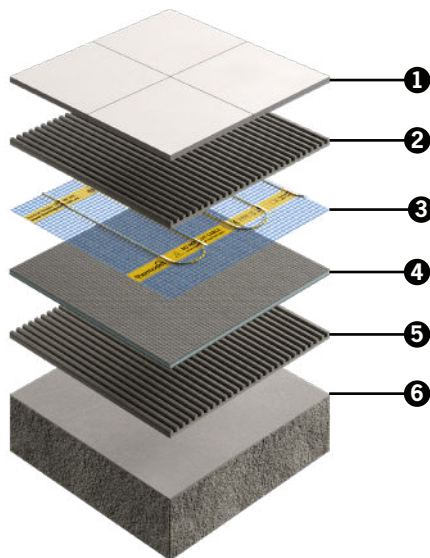

- 1 Tiled floor finish
- 2 Flexible tile adhesive
- 3 Thermonet 150W/m<sup>2</sup> heating mat
- 4 Optional Econoboard insulation board
- 5 Flexible tile adhesive (if insulation is installed)
- 6 Prepared concrete or timber substrate



### Lifetime Warranty

We are so confident of the quality of our Thermonet, Underfloor Heating systems, made in the United Kingdom, that we give each system a warranty that lasts a Lifetime with 3 year warranty on our Thermostats.



### Twisted Twin cable construction

The unique stress free cable construction creates a longer lasting heating cable with zero electromagnetic field (Zero EMF).



### Fully self adhesive mesh

The self adhesive mesh speeds up installation by holding Thermonet matting to the substrate for easy self-levelling and tile fixing.



### Heating cable protection

Thermonet is installed wire side down which means the heating cable is protected from damage during installation by the hard wearing mesh layer.



### Minimal Height Build-up

Utilising innovative extrusion processes provides real 'lay flat' technology that makes installing Thermonet easy. The matting system is only 3.5mm thick with a low profile cold tail of only 4mm thick which is typically concealed within the tile adhesive layer.



**Kit Includes:** Thermonet 150W/m<sup>2</sup> Mat, Dual Control Thermostat (5246), Floor Temperature Sensor, Sensor Conduit, Fixing Tape, Cable Monitor (6025), Installation Guide & Warranty Form.

### Technical Data

Width	500mm
Heated Width	430mm
Thickness	3.5mm*
Max. Temperature	28°C**
Protection Rating	IP68
Warranty	Lifetime on heating mat with 3 years on our Thermostats
Voltage	240Volt
Wattage	150W/m <sup>2</sup>
Conductor Type	Single Ended
Cold Tail Length	5m

\*Cold tail is 4mm thick

\*\*Regulated by floor sensing thermostat

## Installation Overview

Thermonet electric underfloor heating mat is quick and easy to install. This overview gives a guide to the basics. Always read the instructions in full before attempting your own installation.



**1 Plan out the installation**  
Determine the location of the Thermostat and floor sensor and work out the layout of the heating mat excluding areas under floor mounted fixtures.

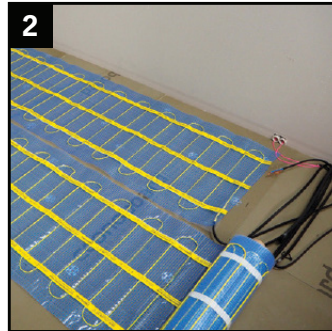

**2 Lay out the Thermonet mat**  
Starting at the Thermostat position, lay out the heating mat according to the plan.

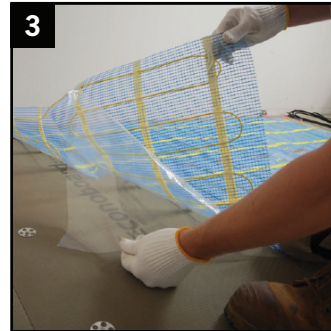

**3 Stick down the heating mat**  
Once the layout is finalised, peel off the clear plastic and stick down the heating mat.



**4 Install floor finish**  
Cover the heating cables with self-levelling compound or tile directly on top using a full bed of tile adhesive.

## Thermonet Mesh 150W/m<sup>2</sup> TDB Kits

Stock Code	Size (m)	Area (m <sup>2</sup> )	Output (W)	Amps (A)	Resistance (Ω)
111502TDB	2 x 0.5	1.0	150	0.63	353
111503TDB	3 x 0.5	1.5	225	0.94	235
111504TDB	4 x 0.5	2.0	300	1.25	176
111505TDB	5 x 0.5	2.5	375	1.56	141
111506TDB	6 x 0.5	3.0	450	1.88	118
111507TDB	7 x 0.5	3.5	525	2.19	101
111508TDB	8 x 0.5	4.0	600	2.50	88
111509TDB	9 x 0.5	4.5	675	2.81	78
111510TDB	10 x 0.5	5.0	750	3.13	71
111511TDB	11 x 0.5	5.5	825	3.44	65
111512TDB	12 x 0.5	6.0	900	3.75	59
111513TDB	13 x 0.5	6.5	975	4.06	56
111514TDB	14 x 0.5	7.0	1050	4.38	50
111516TDB	16 x 0.5	8.0	1200	5.00	44
111518TDB	18 x 0.5	9.0	1350	5.63	39
111520TDB	20 x 0.5	10.0	1500	6.25	35
111524TDB	24 x 0.5	12.0	1800	7.50	29
111528TDB	28 x 0.5	14.0	2100	8.75	25
111532TDB	32 x 0.5	16.0	2400	10.00	22