

5238 Black Facial Kit for 5235W Thermostat

The standard white cover plate and screen surround on the Thermotouch Wi-Fi 5235W units can be swapped out with the 5238 Black Facial Kit.

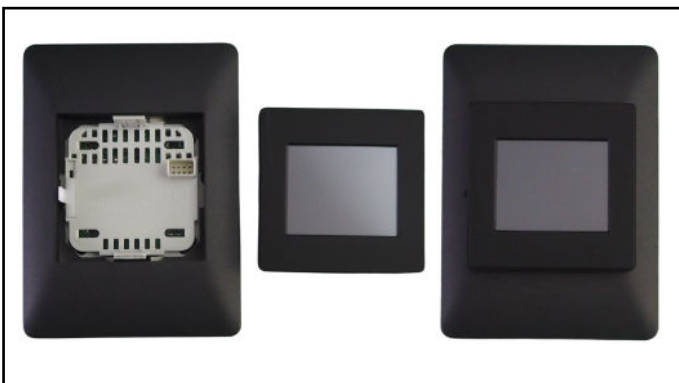
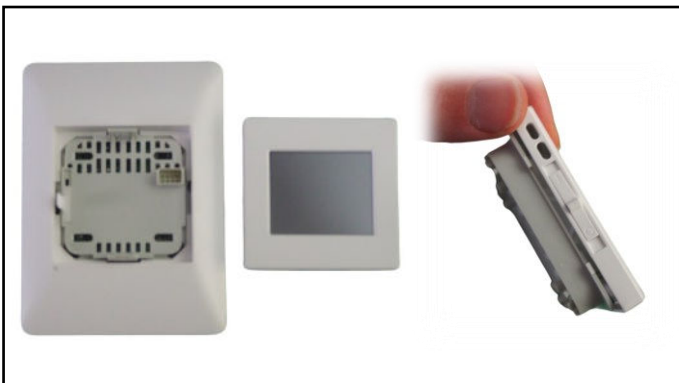

To Swap the Facial Plate:

1. Using a small screwdriver, press up the clip at the bottom of the screen and lever the screen outwards.
2. Unclip the square screen section from the rectangular section.
3. Gently pry off the front white screen cover starting on the left-hand side (side with the switch) and unclipping it at each corner
4. Lift off the white rectangle plate from the grey mounting plate and terminal block.
5. Now install and wire up the thermostat as per the standard 5235W instructions.
6. Once installed, fit the black rectangle plate over the grey mounting plate and terminal block.
7. Clip the black screen cover onto the main screen section ensuring the switch is on the right-hand side and matches the slot on the right-hand side of the screen.
8. Ensure the switch mechanism is in the down position on both the screen section and the grey terminal block section and clip the screen on, matching up the pins on the left-hand side and the switch on the right-hand side.
9. Your black unit is now ready to use.